

# Checking/replacing the battery

## Check the control-unit battery

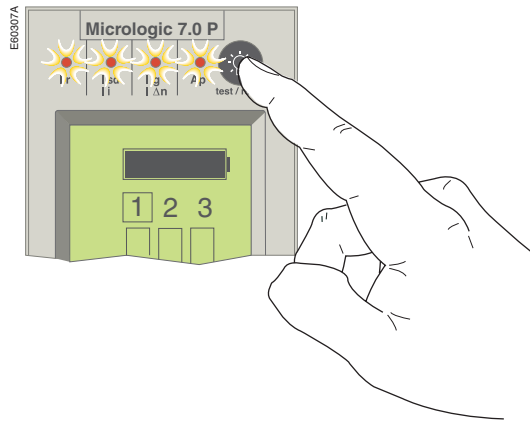

Press and hold down the test button on the control unit to check the LEDs and the battery. The battery information is displayed if the control unit is equipped with an external power supply or if the circuit breaker is ON.

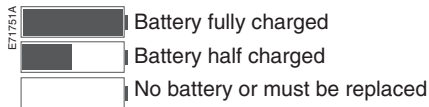

*If the battery needs to be changed, order a new battery with the Schneider Electric catalogue number 33593.*

- lithium battery
- 1.2 AA, 3.6 V, 800 mA/h
- ambient temperature: 130°C.

## Replacing the control-unit battery

1. remove the battery cover

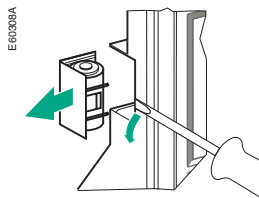

2. remove the battery

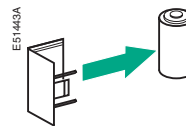

3. insert a new battery. Check the polarity.

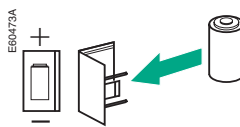

4. put the cover back in place. Press the battery-test button to check the new battery.

